

1/2" DIAPHRAGM PUMP

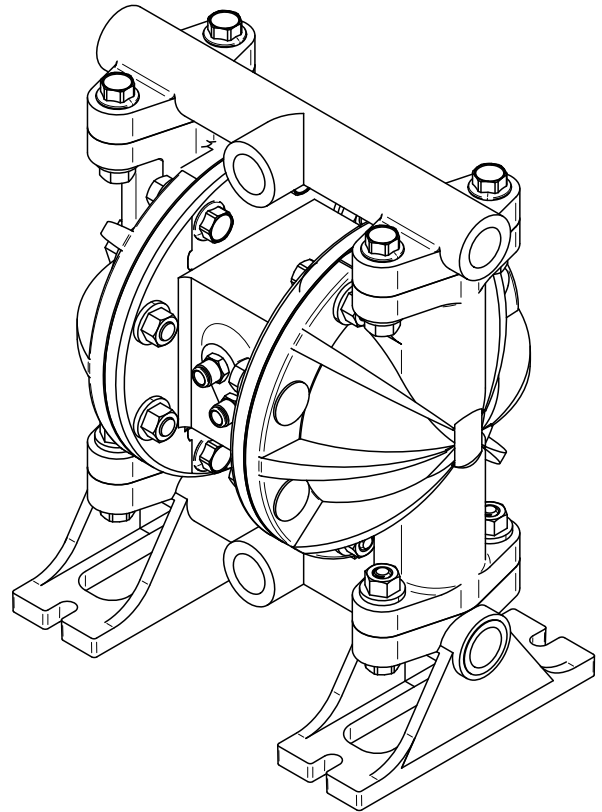

**READ THIS MANUAL CAREFULLY BEFORE INSTALLING,
OPERATING OR SERVICING THIS EQUIPMENT.**

It is the responsibility of the employer to place this information in the hands of the operator. Keep for future reference.

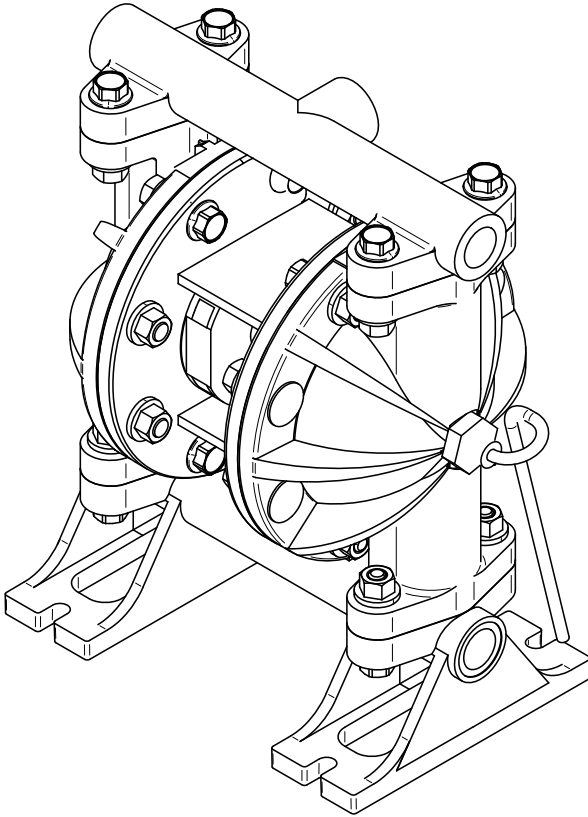

C37013711 VISCOSITY (W/OUT SENSOR)
C37013711-S VISCOSITY SOLVENT
C37013711-W VISCOSITY WATER

C37013710 PUMP
C37013712 PUMP SPLIT

Models See Chart
Pump Type Air Operated, PLC Controlled, Double Diaphragm
Material See Chart
Fluid Caps & Manifold Material Polypropylene
Seat Material Stainless Steel
Check Material Stainless Steel
Diaphragm Material PTFE / Santoprene
Weight 7.2 (3.3 kgs)
Maximum Air Inlet Pressure 80 p.s.i.g. (5.5 bar)
Maximum Material Inlet Pressure 10 p.s.i.g. (0.69 bar)
Maximum Outlet Pressure 80 p.s.i.g. (5.5 bar)

Air Consumption .5 c.f.m. / gallon (approx.)
Maximum Flow Rate 1.25 g.p.m. (49.2 l.p.m.)
Maximum Particle Size 3/32" dia. (2.4 mm)
Maximum Temperature Limits
E.P.R. -60_ to 280_ F (-51_ to 138_ C)
Polypropylene 35_ to 175_ F (2_ to 79_ C)
SantopreneR -40_ to 225_ F (-40_ to 107_ C)
PTFE 40_ to 225_ F (4_ to 107_ C)
Noise Level @ 70 p.s.i., 60 c.p.m. 71.1 db(A)

SERVICE KITS

C37013715--for fluid section repair.
C37013714--for air section repair.